

Wind/Light/Rain Sensor Manual V. 1.0.1

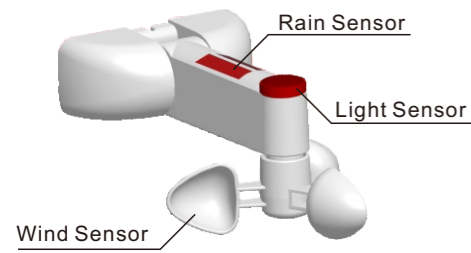

I. Specifications

- ◆Unique shape with patent;
- ◆UV material plastic cover, be suitable for outdoor installation;
- ◆Wind sensor parts utilize double stainless bearings to ensure high sensitivity;
- ◆Laser printing on adjustment knob, clearly look and lasting adhesion.;
- ◆3 optional installation ways;
- ◆Precise strength adjustment, more sensitivity .

II. Parameters

- ◆Receiver working voltage:AC230V/50Hz (optional120V/60Hz)
- ◆Transmitter working voltage:DC3V(battery:AAA*2)
- ◆Sensor frequency: 433. 92MHz(optional 315MHz)
- ◆Receiver loading power: <800W
- ◆Sensor working voltage:DC12V
- ◆Sensor working temperature: -20°C~+85°C

⚠ Installation Notice

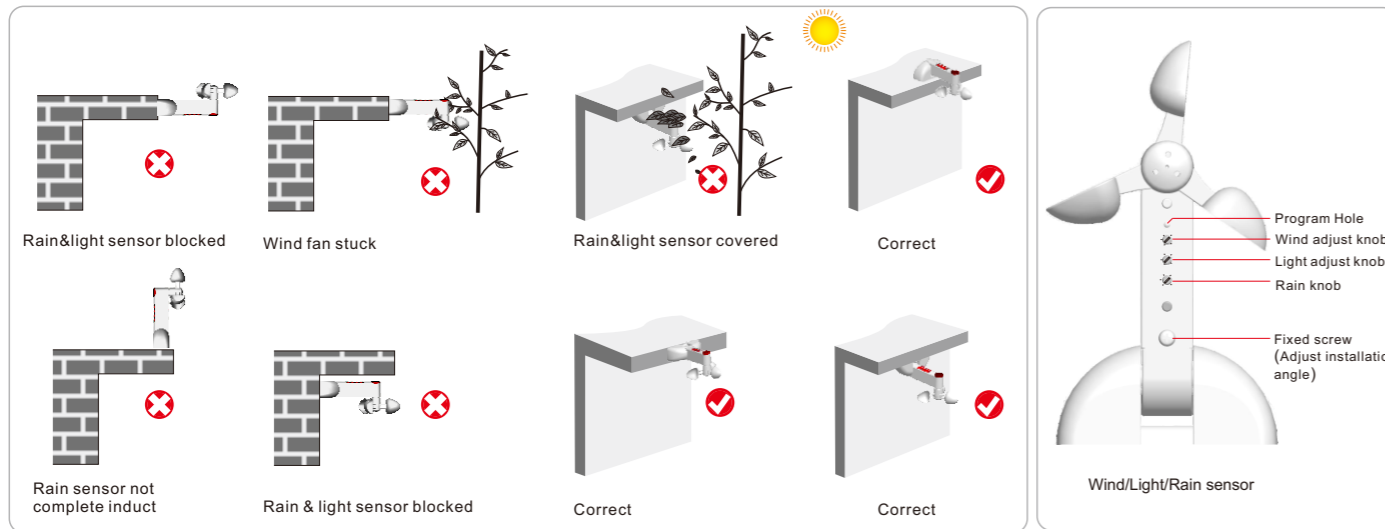

Usage

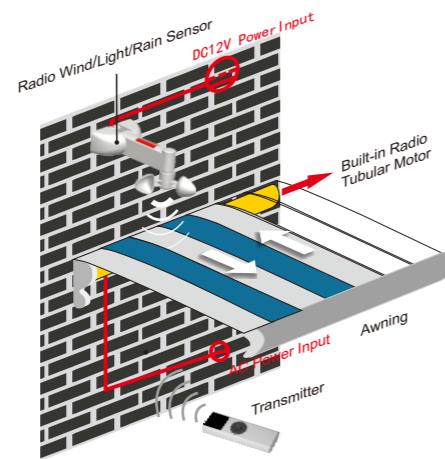

Installation

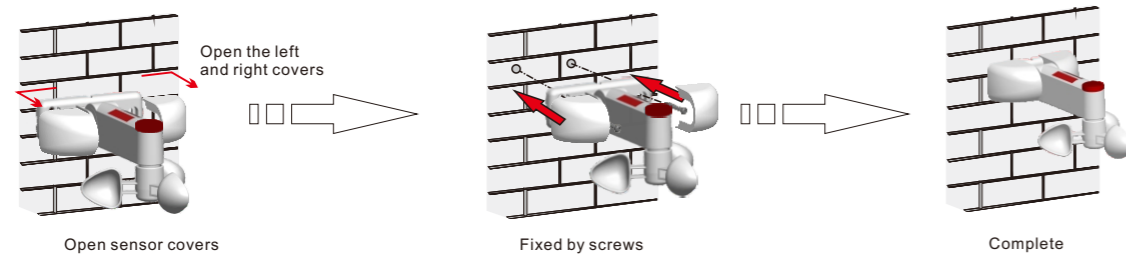

Program and Adjustment

*Below operation must be operated in the condition of correct wiring power

Wind,Light,Rain Sensor work with built-in motor

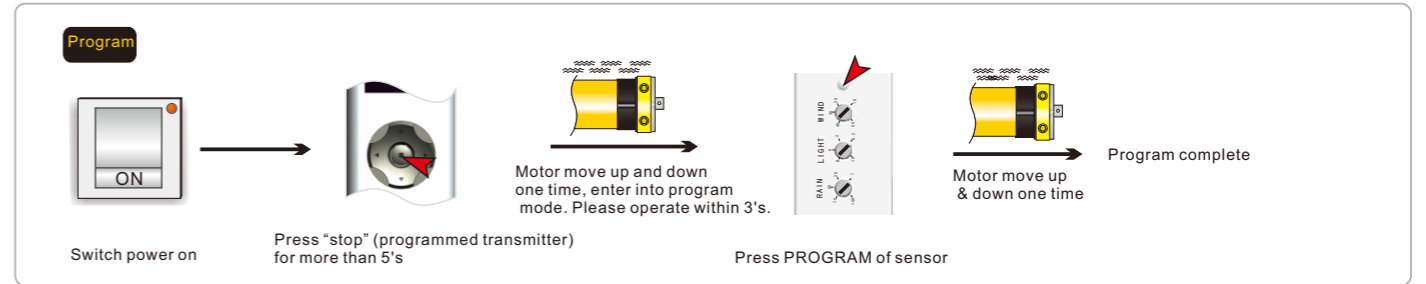

Set Sensor Value

1 Set wind value

Wind speed	10Km/H	20Km/H	30Km/H	40Km/H	50Km/H
Wind force	2 class	4 class	5 class	6 class	7 class

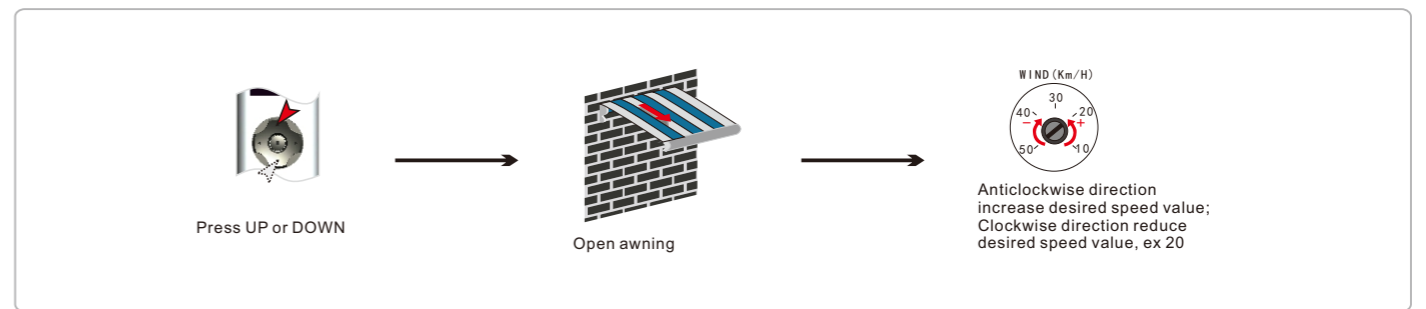

2 Set light value

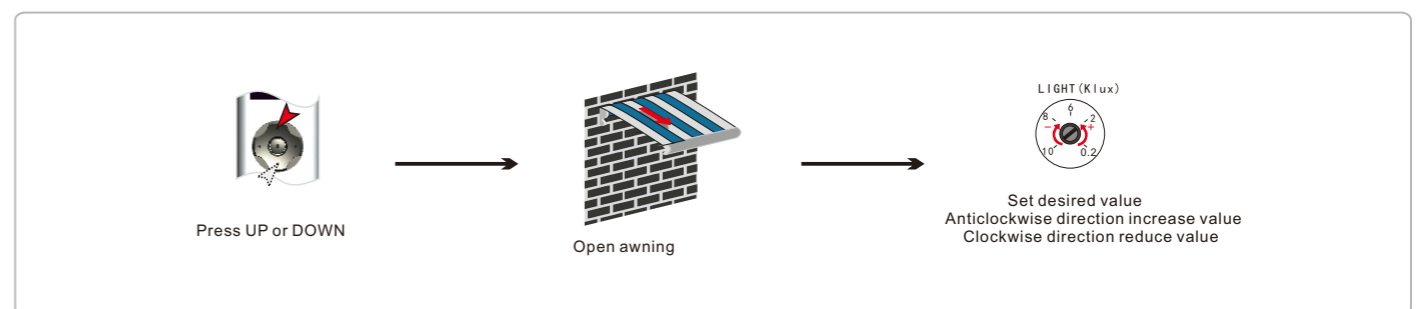

3 Set Rain value

